

Combination, Fashion Finish 60" Wall & 60" Cart-Mate, Base Cabinet/Cart Left

158060ML CABINET

- Fashion Finish wall cabinet with 3 doors, and 2 adjustable shelves
- Fashion Finish base cabinet with 2 doors, 2 adjustable shelves, 2 drawers and cart-port
- Durable, easy-clean, thermofoil surfaces
- No front facing seams on Fashion Finish components
- Unit is pre-assembled to save installation time
- Fully adjustable, soft-close hinges
- 3.25" backsplash included with top
- Satin finish pulls
- Optional sink positioned as shown
- Choice of 3 Fashion Finish colors
- Choice of 6 laminate top colors
- Door locks available

CART

- Fashion Finish cabinet mounted on four, locking, 3" swivel casters
- 4 soft-close drawers that hold up to 75 lbs. each
- ClintonClean™ solid plastic bumper
- One-piece, vacuum-formed, gray-haircell, textured, top rimmed on all sides
- Satin finish pulls
- Fashion Finish color to match cabinet
- Drawer locks available

CART-MATE CABINETS™

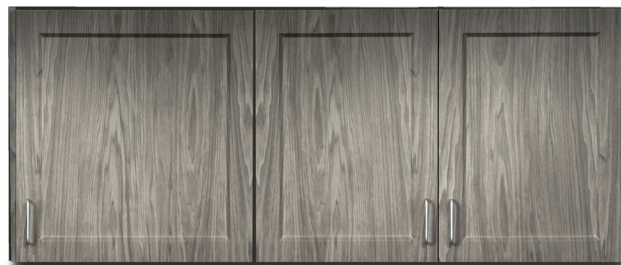

Shown with -022 optional sink

fashionfinish
CASEWORK BY CLINTON



California residents please be advised of the following, pursuant to Proposition 65:

1
WARNING: This product can expose you to chemicals, including chromium, which is known to the State of California to cause cancer or reproductive toxicity. For more information go to www.P65Warnings.ca.gov.

OVERALL WALL CABINET SPECIFICATIONS

60" W x 12" D x 24" H

OVERALL BASE CABINET SPECIFICATIONS

60" W x 18" D x 35" H

OVERALL CART SPECIFICATIONS

20" W x 18.5" D x 29.5" H

OPTIONS

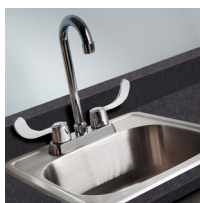

022 Stainless Steel sink and chrome faucet set

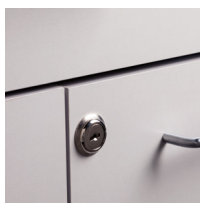

055 Door & Drawer Locks

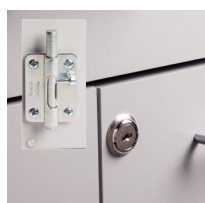

066 Door Locks & Inside Latch



044 Add a Drawer cannot be used with a sink option



42 Cart Option

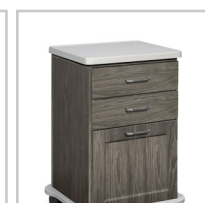

43 Cart Option

Cabinet and Countertop colors



Fashion Finish Cabinet Colors



Twilight



Arctic White



Metropolis Gray

Laminate Countertop Colors

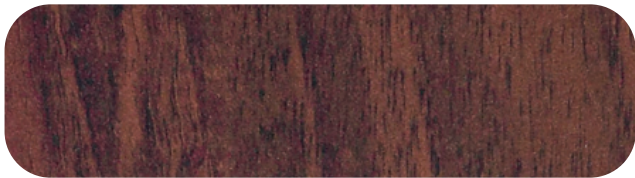

Dark Cherry



Maple



Slate Gray

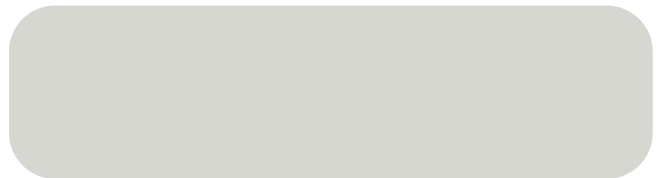

Gray



Classic Marble

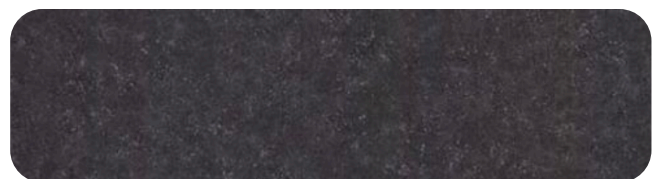

Graphite Talc

NOTE: *Classic Marble* laminate mirrors the beauty of actual marble, so as with actual marble, the veining can vary in width and color intensity.