

## Combination 60" Wall & 60" Cart-Mate, Base Cabinet/Cart Right

### 148060R CABINETS

- All laminate wall cabinet with 3 doors, and 2 adjustable shelves
- All laminate base cabinet with 2 doors, 2 adjustable shelves, 2 drawers and cart-port
- Easy-clean, all laminate surfaces
- Tough, chip resistant edges
- Unit is pre-assembled to save installation time
- Fully adjustable, soft-close hinges
- 3.25" backsplash included with top
- Satin finish pulls
- Choice of solid color or woodgrain laminate finishes for cabinet
- Choice of 6 laminate countertop finishes
- Door locks available

### CART

- All laminate cabinet mounted on four, locking, 3" swivel casters
- 4 soft-close drawers that hold up to 75 lbs. each
- ClintonClean™ solid plastic bumper
- One-piece, vacuum-formed, gray-haircell, textured, top rimmed on all sides
- Satin finish pulls
- Choice of solid color or woodgrain laminates
- Drawer locks available

### CARTMATE™ CABINETS



*Shown with optional sink*

#### OVERALL WALL CABINET SPECIFICATIONS

60" W x 12" D x 24" H

#### OVERALL BASE CABINET SPECIFICATIONS

60" W x 18" D x 35" H

#### OVERALL CART SPECIFICATIONS

20" W x 18.5" D x 29.5" H

CLASSIC CLINTON  
• LAMINATE CASEWORK •



California residents please be advised of the following, pursuant to Proposition 65:



**WARNING:** This product can expose you to chemicals, including chromium, which is known to the State of California to cause cancer or reproductive toxicity. For more information go to [www.P65Warnings.ca.gov](http://www.P65Warnings.ca.gov).

1

### OPTIONS



022 Stainless Steel sink and chrome faucet set

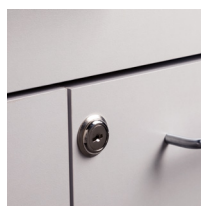

055 Door & Drawer Locks

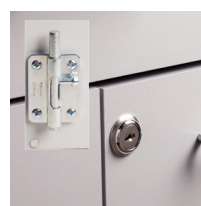

066 Door Locks & Inside Latch

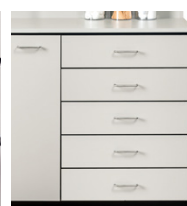

044 Add a Drawer cannot be used with a sink option



42 Cart Option



43 Cart Option

## Cabinet and Countertop colors

**CLASSIC CLINTON**  
•LAMINATE CASEWORK•

### Laminate Cabinet Colors



*Dark Cherry*

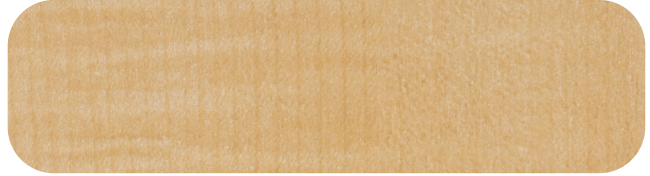

*Maple*



*Slate Gray*

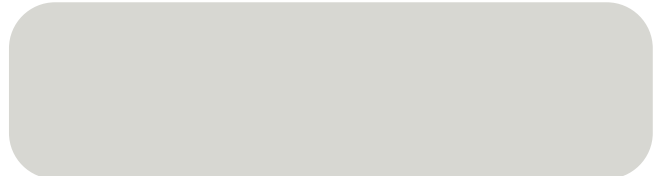

*Gray*

### Laminate Countertop Colors

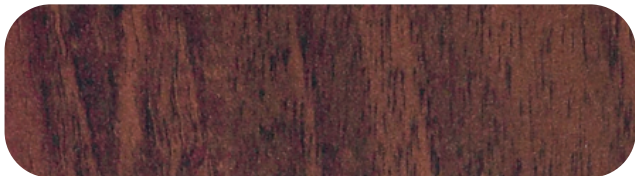

*Dark Cherry*



*Maple*



*Slate Gray*

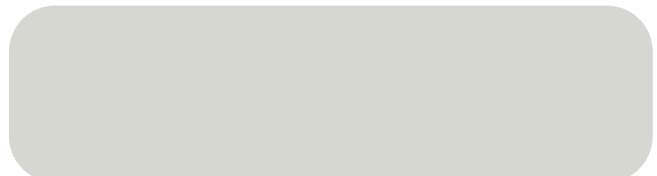

*Gray*



*Classic Marble*

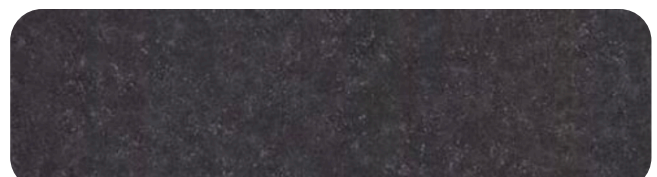

*Graphite Talc*

**NOTE:** *Classic Marble* laminate mirrors the beauty of actual marble, so as with actual marble, the veining can vary in width and color intensity.